



GRIFFIN

FABRICATION CATALOG

STRUCTURES | BENCHING | PLANT STANDS

2025

A FAMILY OWNED SINGLE SOURCE SUPPLIER
FOR ALL YOUR HORTICULTURAL NEEDS

ABOUT GRIFFIN

Griffin is a partner to horticulture professionals. Family owned and operated since 1947, we apply our knowledge, experience and resources to enhance customer success from production to retail.

End-to-end solutions are our specialty. We represent the industry's leading breeders and producers, spanning seed and vegetative, bedding and potted crops, ornamentals and edibles. Our grower supplies offer includes reliable inputs and equipment to help your crops thrive through all production stages. Finally, our quality retail products drive add-on sales for you, while enhancing consumer success and enjoyment.

To learn more about our company, we invite you to visit us online at www.griffins.com, follow us on LinkedIn, Instagram and Facebook.

A LEGACY OF QUALITY AND SERVICE

Charlie Griffin founded his namesake company in 1947 with a simple vision: To maximize products and service for his customers. Originally headquartered in Reading, Mass., his was a one-man operation with a limited offering, delivering supplies to growers in the local community.

Ken Hyslip, Sr. first became an employee of Griffin Greenhouse Supplies in 1952, as a truck driver at the age of 17. At the time, Griffin operated from a single location with no more than five employees. He went on to buy the business from the Griffin family in 1968. Under his leadership, Griffin grew steadily across the East Coast.

Today, Griffin thrives among horticulture's premier distributors, serving growers and retailers nationwide. Under the leadership of the Hyslip family, the business has earned a reputation for operational excellence, quality products, and first-class customer service.

We know you have many choices among supplier partners, and we sincerely thank you for your business. We look forward to serving you in the season ahead.

GRIFFIN IS COMMITTED TO EXCEPTIONAL CUSTOMER SERVICE

Our goal is simple: To meet your needs and exceed your expectations. From the time you place your order until it's delivered to your location, our team works to treat you with the utmost care every step of the way.

We strive to deliver every order on time and in full. We'll contact you 24 hours before your delivery date to ensure you're ready for the product. If we're unable to honor a delivery date, we'll notify you in advance and make every effort to reschedule at a time that's convenient for you. In the event of any issue, we're dedicated to working with you and our suppliers as needed to find a swift resolution.

Your opinion matters to us! Customer feedback is key to helping our team deliver on our service pledge. Please don't hesitate to contact me directly – by phone or e-mail – with any questions or input that may help us serve you better.

Dan Lowery | Corporate Customer Service Manager | 800.888.0054 x81404 | dlowery@griffinmail.com



GRIFFIN LOCATIONS

*Fifteen Distribution Centers
Throughout the United States*

TO PLACE AN ORDER

Online: www.griffins.com

Phone: 1.800.888.0054 & press 3

E-mail: ConstructionDept@griffinmail.com

GENERAL QUESTIONS

1.800.888.0054 & press 3

OFFICE HOURS

Our office is open for normal business
and telephone service from 8:00 AM to
5:00 PM, Monday through Friday.

WAREHOUSES

Hours for pick-up orders and counter
sales are 8:00AM to 5:00PM, local time,
Monday through Friday.

BRANCH LOCATIONS

5303 Havana St, Suite 120
Denver, CO 80239

1240 B Hwy 77
Bridgeton, NJ 08302

20 Grandview Ct
Cheshire, CT 06410

1 Ellis Dr
Auburn, NY 13021

10 Middle River Drive
Stafford Springs, CT 06076

2165 Montauk Hwy
Brookhaven, NY 11719

111 Bluffs Court, Suite A
Canton, GA 30114

126 Van Guysling Ave
Schenectady, NY 12305

2143 Internationale Parkway
Suite 400, Woodridge, IL
60517

28214 Glenwood Rd.
#4855, Perrysburg, OH

1619 Main St
Tewksbury, MA 01876

58 S.E. 223rd Ave.,
Gresham, OR 97030

50 W Gray Rd
Gray, ME 04039

200 Mountain View Rd
Morgantown, PA 19543

5612 Pride Rd
Richmond, VA 23224



SOURCING HAS NEVER BEEN THIS SIMPLE

One login connects you to the industry's broadest selection of products for growers and independent retailers:



- Green goods including seed, cuttings and young plants
- Production supplies including containers, growing media and plant protection products
- Greenhouse structures and equipment
- Retail supplies including lawn & garden products, accessories and gift items
- Custom banners, greenhouse signs and holders

Place your order today: **www.griffins.com**



CHECK OUT OUR
CLEARANCE ITEMS!

GREENHOUSE STRUCTURES

30' E-ZY GROWER GOTHIC GREENHOUSE

30' GOTHIC SPECIFICATIONS

Bows: 1.66, 14 gauge galvanized steel tubing
Optional 1.990, 13 gauge bows available upon request

Purlins: 1.315, 18 gauge galvanized steel tubing

30' STANDARD-WALL

- Height at Peak: 12'10"
- Height 3' from Side: 6'3"
- Groundpost: 36" (4" above ground)
- Poly Width: 42'

30' MID-WALL

- Height at Peak: 13'8"
- Height 3' from Side: 8'1"
- Groundpost: 54" (26" above ground)
- Poly Width: 48'

30' HIGH-WALL

- Height at Peak: 15'10"
- Height 3' from Side: 10'4"
- Groundpost: 84" (54" above ground)
- Poly Width: 50'

COMMON LENGTHS

***Pre-made kits made in the following lengths**

WALL FRAME

- 30' x 48' Frame
- 30' x 72' Frame
- 30' x 100' Frame
- 30' x 144' Frame

WALL FRAMES INCLUDE

4' bow spacing, 3 purlins, cross bracing every other bow, wind bracing on all 4 corners. End-Wall Frames are not included, please specify if needed

HAVE A CUSTOM NEED OR LENGTH?

We help you solve this by emailing
constructiondept@griffinmail.com
or call 800.888.0054 & PRESS 3



GREENHOUSE STRUCTURES

21' & 24' E-ZY GROWER GOTHIC GREENHOUSE

21' GOTHIC SPECIFICATIONS

Bows: 1.315, 14 gauge galvanized steel tubing
Optional 1.660 14 gauge OR 1.990 13 gauge bows available upon request

Purlins: 1.315, 18 gauge galvanized steel tubing

21' STANDARD-WALL

- Height at Peak: 10'3"
- Height 3' from Side: 5'11"
- Groundpost: 36" (4" above ground)
- Poly Width: 32'

21' MID-WALL

- Height at Peak: 11'9"
- Height 3' from Side: 7'5"
- Groundpost: 54" (26" above ground)
- Poly Width: 36'

24' GOTHIC SPECIFICATIONS

Bows: 1.315, 14 gauge galvanized steel tubing
Optional 1.660 14 gauge OR 1.990 13 gauge bows available upon request

Purlins: 1.315, 18 gauge galvanized steel tubing

24' STANDARD-WALL

- Height at Peak: 12'0"
- Height 3' from Side: 6'3"
- Groundpost: 36" (4" above ground)
- Poly Width: 36'

24' MID-WALL

- Height at Peak: 13'8"
- Height 3' from Side: 7'6"
- Groundpost: 54" (26" above ground)
- Poly Width: 40'

COMMON LENGTHS

***Pre-made kits made in the following lengths**

WALL FRAME

- 21/24' x 48' Frame
- 21/24' x 72' Frame
- 21/24' x 100' Frame
- 21/24' x 144' Frame

WALL FRAMES INCLUDE

4' bow spacing, 3 purlins, cross bracing every other bow, wind bracing on all 4 corners. End-Wall Frames are not included, please specify if needed

HAVE A CUSTOM NEED OR LENGTH?

We help you solve this by emailing
constructiondept@griffinmail.com
or call 800.888.0054 & PRESS 3



GREENHOUSE STRUCTURES

15' & 20' E-ZY GROWER WINTER CHALET

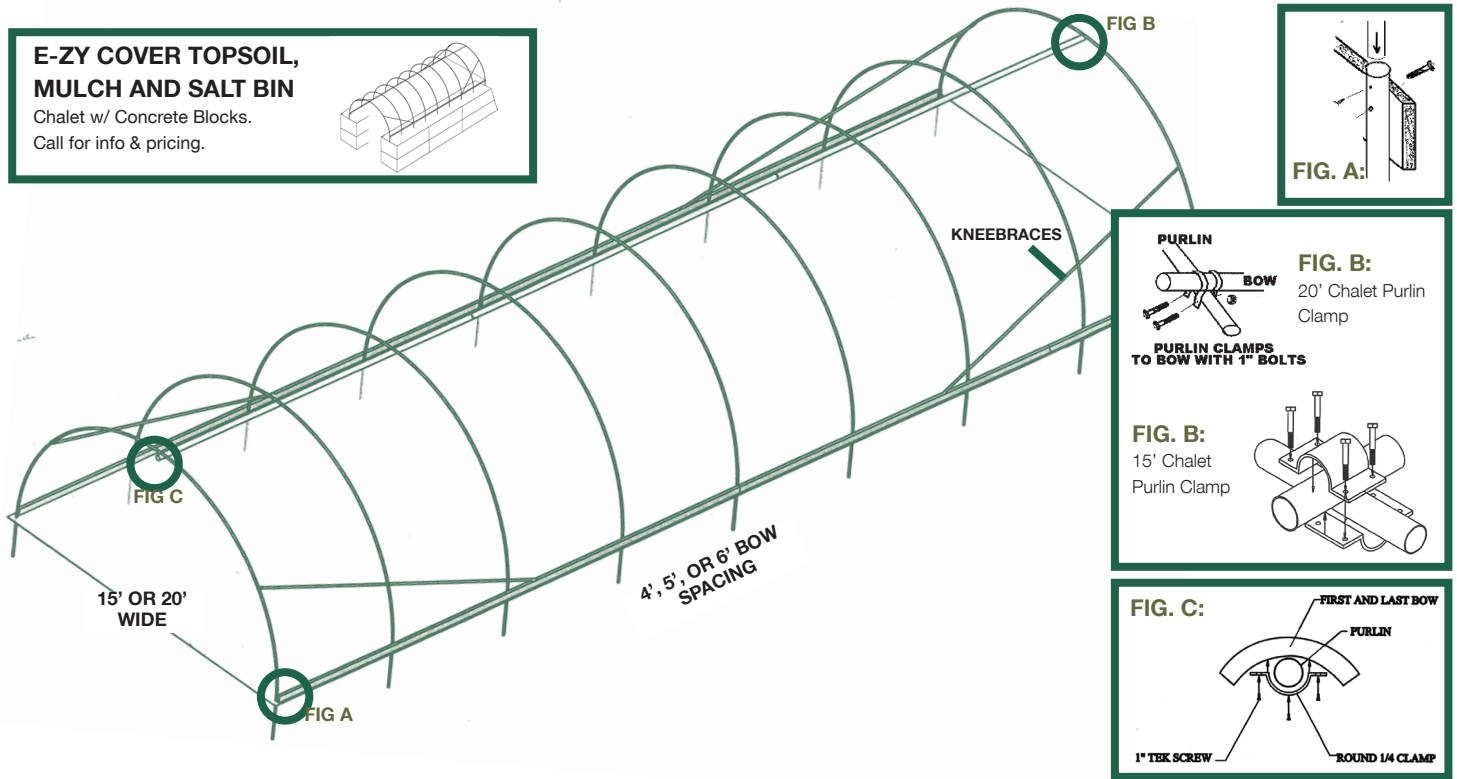

15' WINTER CHALET SPECS

Bows: 1", 14 gauge tubing

Purlins: 1.315, 18 gauge tubing

- Height at Peak: 7'3"
- Height 3' from Side: 5'9"
- Groundpost: 24' (2" above ground)
- Poly Width: 24'

20' WINTER CHALET SPECS

Bows: 1.315", 14 gauge tubing

Purlins: 1.315, 18 gauge tubing

- Height at Peak: 10'0"
- Height 3' from Side: 8'0"
- Groundpost: 36' (2" above ground)
- Poly Width: 32'

COMMON LENGTHS

*Pre-made kits made in the following lengths

WALL FRAME

- 15/20' x 48' Frame
- 15/20' x 72' Frame
- 15/20' x 100' Frame
- 15/20' x 144' Frame

WALL FRAMES INCLUDE

4' bow spacing, 1 purlin & wind bracing on all 4 corners.

The E-ZY Grower Winter Chalet is designed to protect your valuable nursery stock, perennials, roses, bedding plants and more from snow loads, strong winds and other bad weather. The E-ZY Grower Winter Chalet is well designed for long term economic overwintering, storage and growing space. The 15' Winter Chalet bow is made of a single piece of curved steel. While the 20' Winter Chalet bow uses two pieces of curved steel, one side swedged to fit into the other.

GREENHOUSE BENCHING



E-ZY GROWER BENCH FRAME

Help your grower / retailer customers maximize their greenhouse space with custom E-ZY Grower Benches. Our benches can be set in concrete or placed above ground on a solid foundation. Leg sets are made of 14 gauge steel tubing. Bench framing is made of aluminum "F" rail around the perimeter, connected every 2' with a 1" sq. piece of steel tubing.

OUR FABRICATION DEPARTMENT MAKES YOUR CUSTOM ORDER EASY!

- Bench top only
- Full bench stationary or rolling
- Bench width of 3', 4', 5', 5½', 6', or 6½'
- Legs set in concrete or on solid foundation
- Lengths divisible by 6' or 8' are standard, other lengths are considered custom.
- Steel corner splices

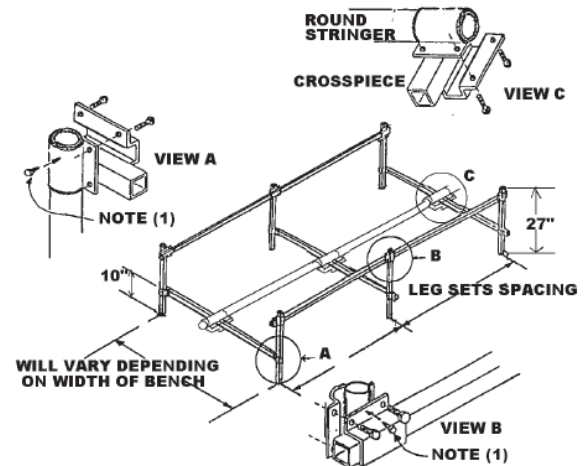

(1) AFTER IMPORTANT LEVELING OF FRAMEWORK, INSTALL A #10 X 3/4" TEK SCREW TO LOCK FRAME IN PLACE.

ADVANTAGES OFFERED OVER THE COMPETITION:

- Bench top cross pieces are 1' x 1' and 1' x 2' 16 gauge steel; not 18 gauge as many.
- We use 1' x 2' rectangular steel where ends of expanded metal join for easier more positive support.
- For retail use we offer optional attractive high density polyethylene rounded corners.
- We use round tubing for legs for easier installation.
- Rollers are 14 gauge steel 1-3/8" not the 16 or 17 gauge that others use, or the 1-1/4" diameter tubing, which can become egg-shaped over time. Option of using 1-3/8" diameter is offered for extra long benches or benches that are heavily loaded.

EXPANDED METAL SHEETS FOR BENCH TOPS



Sizes:
Stock Lengths 6' or 8'
Widths: 4', 5', 5.5', 6', 6.5'

- Continuous Air Flow - Reduces fungus by allowing unrestricted air passages.
- Extra Long Life - Hot dip galvanized zinc coating after expansion. This is the best available and will greatly outlast cheaper grades that are galvanized before expansion.
- Drainage - 76% open area allows pots to sit level.
- No Maintenance - Soil and water drop right through the bench - eliminating weed, soil, and water accumulation.
- Light Weight - 94 lb. per hundred square feet.
- Low Cost - You'll find this bench to be more economical than most bench material now used.

CUSTOM SIZES - CALL FOR QUOTE!

GREENHOUSE BENCHING

BENCHES ALSO AVAILABLE WITH
BLACK A-V INTERLOCKING TOPS



A-V PLASTIC BENCH TOP INTERLOCK DETAILS

18 x 36

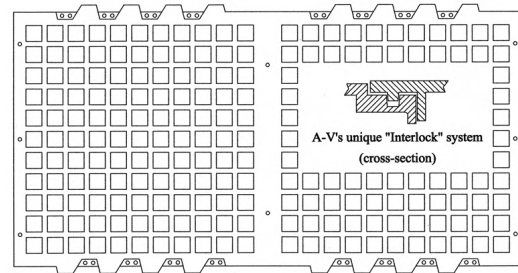

24 x 48

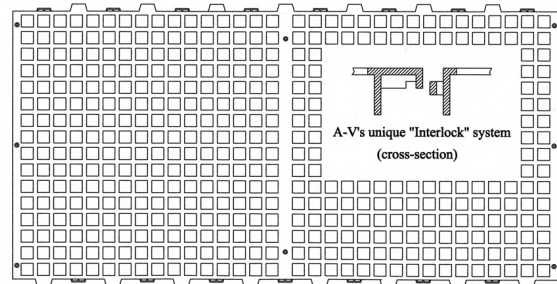

- Two Sizes: 18" x 36" & 24" x 48"
- Easy to Clean & Disinfect
- Polypropylene, UV Protected
- No Rust, Rot, or Decay
- Strong, Durable, & Lightweight
- Suitable for Walking or Standing when Properly Supported
- Flats, Trays, & Pots Slide Easily
- No Protruding Wires or Jagged Metal Edges
- Easy, Positive Interlocking Feature, No Clips Required
- Installs on Any Type Frame
- Can be Purchased Separately

GREENHOUSE PARTS

E-ZY ROLL TUBE

Our aluminum roll tube is designed with a built-in track to allow for easy installation of poly for poly roll-up vents. Simply secure poly in track with stainless steel wire (spring) insert. Need to change the poly? Just remove the spring, add a new piece of poly and put the old spring back in.

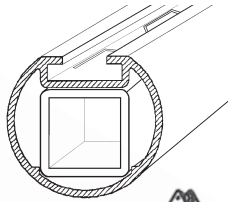
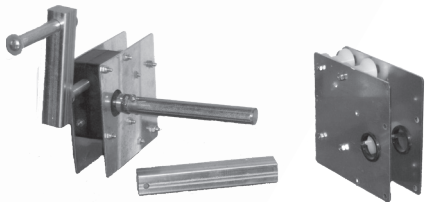

Diagram above shows order of installation of E-ZY Grower Roll Tube with adapters into guide and gear box.

CATALOG #	DESCRIPTION
1240 3316	E-ZY Roll Tube Splice #RVM316
1240 3317	E-ZY Roll Guide Box Adapter Swaged #RVM317
1240 3318	E-ZY Roll Tube Into Guidebox #RVM318
1305 2048	4' Wire Insert Only
1329 1144	12' E-ZY Roll Tube
1329 1288	24' E-ZY Roll Tube
1240 3316	E-ZY Roll Tube Splice #RVM316
1240 3305	Crank Handle for E-ZY Grower Gear Box #RVM303
1201 0104	Kankit Gearbox
1240 3321	Roll Up Vent Bracket - #RUM321
1742 2400	2-1/2" Hairpin/Cotter Key
1240 3301	E-ZY Gear Box with Handle
1240 3303	E-ZY Grower Guide Box



E-ZY Gear Box with Crank Handle



Kankit 104



Cotter Key

E-ZY SPRING HOOK

Our E-ZY Spring Hook holds web or battening tape firmly in the lock base to secure poly and prevent flapping. The wire insert design allows you to easily slide it into poly lock base track at top and bottom of rollup side vent. Hook is installed in upward position on top lock base track and downward position in baseboard lock base track. Once installed, simply weave web / battening tape in a 'V' formation from vent top to vent bottom. Eliminates the need for tools and hardware!

CATALOG #	DESCRIPTION
1305 2049	E-ZY Spring Hook

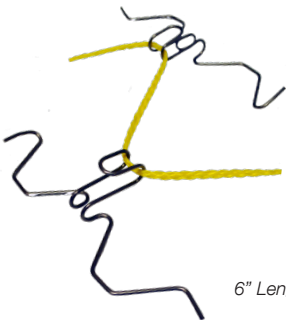

6" Length X 2" Hook

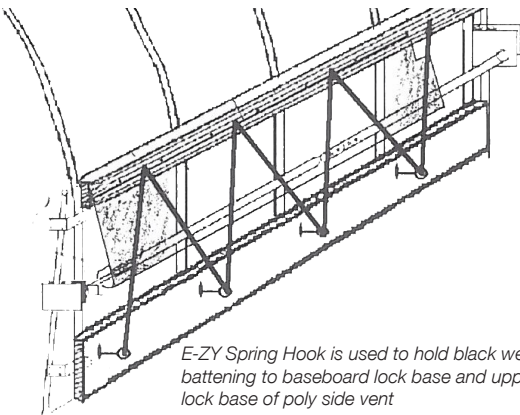

E-ZY Spring Hook is used to hold black web / battening to baseboard lock base and upper lock base of poly side vent

GREENHOUSE PARTS

ALUMINUM PROFILE/EXTRUSIONS

QUICK LOCK MALE INSERT

For use with Single & Double Quick Lock Base. The Quick Lock Male Insert turns easily into the Quick Lock Base to hold two layers of greenhouse poly cover. Poly is securely locked after air is inflated between the two poly layers to 'seat' the insert. When the time comes to change out poly a quarter turn of the insert is all you need to release it from the base.

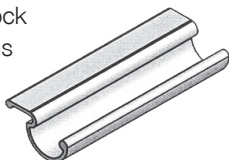

CATALOG #	DESCRIPTION
1304 1048	4' Quick Lock Male Insert

QUICK LOCK BASE /DOUBLE & SINGLE

RECOMMENDED FOR USE WITH DOUBLE LAYER INFLATED POLY ONLY.

Quickly and easily attach and replace double layer poly on your greenhouse frame with our rigid locking system. Use Single Quick Lock Base to attach poly to baseboards at the sides and ends of your greenhouse. We recommend 1/4" x 1" hex head bolts w/ nuts for attaching Single Quick Lock Base to a steel frame. Our Double Quick Lock Base is designed for use at the top of an E-ZY-Grower Roll-up side vent to secure both roof and side wall poly in one base track. The double base is rigid enough to be attached across greenhouse bows (up to 5' spacing) with out horizontal support. Use #10 x 3/4" tek screws to attach to steel framing or 1/4" size bolts when attaching to wood. Both Single and Double Quick Lock Bases are used in conjunction with Quick Lock Male Insert described above.

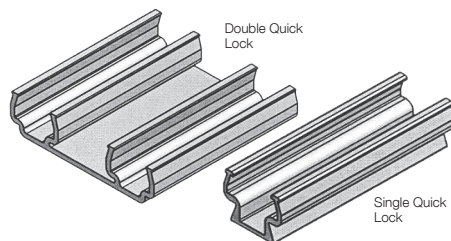

CATALOG #	DESCRIPTION
1303 1144	12' Double Quick Lock Base
1303 1288	24' Double Quick Lock Base
1302 1144	12' Single Quick Lock Base
1302 1288	24' Single Quick Lock Base

WIRE INSERT

The stainless steel wire insert, which is sometimes called a spring, will not change its' holding characteristics even with repeated use. When installing, simply pull the material across the base channel, and snap the soft wire insert into place to secure the material.

Distributor sales in bundle of 50



CATALOG #	DESCRIPTION
1305 2048	4' Stainless Steel Wire Insert 50/bundle
1305 2072	6' Stainless Steel Wire Insert 50/bundle

WIRE POLY LOCK

Use the steel Wire Poly Lock extrusion to secure poly along baseboards and along the curve of bows. We suggest that two springs be used for added strength in windy areas. Wire Poly Lock can be attached to most steel greenhouse frames. Secure with 1/4" x 1" tek screws every 18" when attaching extrusion to steel baseboards or bows. It is recommended to use 1/4" hex bolts with nuts when attaching extrusion to Greenhouse Frame.

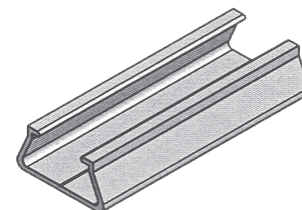

CATALOG #	DESCRIPTION
1306 1144	12' Wire Poly Lock Base
1306 1288	24' Wire Poly Lock Base

UNIVERSAL SPRING LOCK

Universal Spring Lock easily, neatly and inexpensively finishes end walls. It securely attaches poly or shade cloth to any round, oblong or square tubing and allows for 8mm polycarbonate or 'raised rib' sheets under its cap.

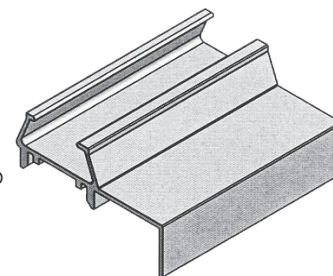

CATALOG #	DESCRIPTION
1307 1288	24' Universal Spring Lock

GREENHOUSE PARTS

LARGE H PROFILE

Use the 8mm aluminum Large H profile to splice two pieces of polycarbonate together on any flat surface. The Large H profile can be attached to most steel greenhouse frames with 1/4" x 1" tek screws.

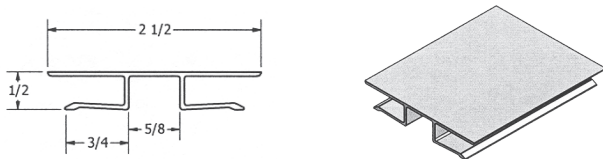

CATALOG #	DESCRIPTION
1310 1144	12' Large H Aluminum Profile
1310 1288	24' Large H Aluminum Profile

SMALL H PROFILE

Use the 8mm aluminum Small h profile to attach and seal edges of polycarbonate to a structure. The Small h profile can be attached to most steel greenhouse frames with #10 x 3/4" tek screws.

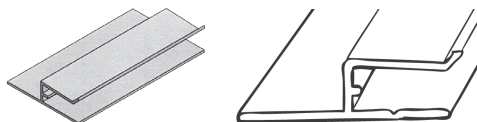

CATALOG #	DESCRIPTION
1311 1144	12' Small H Aluminum Profile
1311 1288	24' Small H Aluminum Profile

ALUMINUM LATH

Economical answer to attaching poly to round tubing! Aluminum Lath is used on the end bows of a steel greenhouse structure or an inexpensive alternative for attaching poly to roll tube for poly roll-up vents. Use 1/4" x 1" tek screws every 18" to secure.

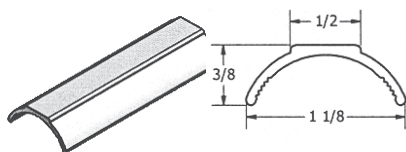

CATALOG #	DESCRIPTION
1309 1193	16'1" Aluminum Lath

BAR BASE & BAR CAP

Bar Base and Bar Cap are used together to form a two-piece profile similar to the Large H profile. The advantage of having two separate pieces is that it makes attaching polycarbonate to a curved surface much easier. Bar Base can be attached to most steel greenhouse frames with #10 x 3/4" or 1/4" x 1" tek screws. Use Phillips PanHead Screws 1/2" long to attach BarCap to the Base every 12" to 18".

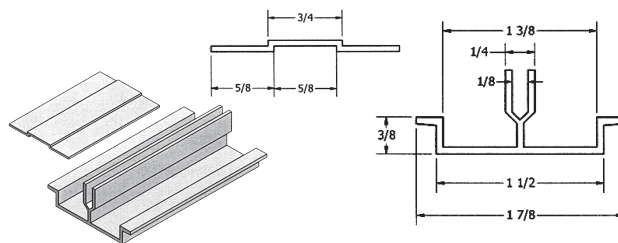

CATALOG #	DESCRIPTION
1312 1290	24'2" Bar Base Aluminum Profile
1313 1290	24'2" Bar Cap Aluminum Profile

ALUMINUM U-CHANNEL

Used with Bar Base to seal top and bottom edge of polycarbonate sheets.

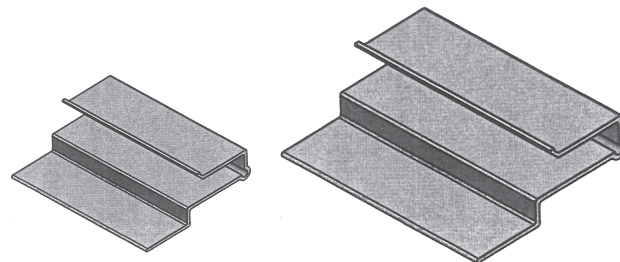

CATALOG #	DESCRIPTION
1314 1144	12' Aluminum U-Channel
1314 1288	24' Aluminum U-Channel

GREENHOUSE PARTS

POLY VENT SPRING LOCK

Used at the bottom edge of a poly vent. Unique position of channel allows water to pass over vent seal area. Fits 1-1/4" square steel vent arms.

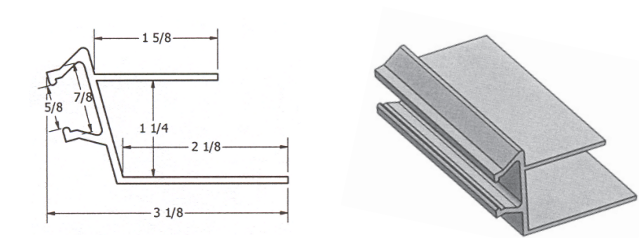

CATALOG #	DESCRIPTION
1308 1288	24' Poly Vent Spring Lock

UNIVERSAL SLAM RAIL

Universal Slam Rail is used with Universal Vent Rail to create a water-tight seal. Designed to seal both the vent and the greenhouse poly, thus cutting down on the expense of using two extrusions! Attach Universal Slam Rail to bows or outside purlins with bolts every 18".

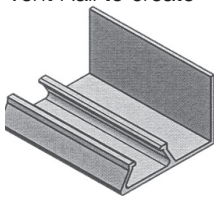

CATALOG #	DESCRIPTION
1323 1288	24' Universal Slam Rail

DOOR BRUSH SEAL

Door brush seal is used around sliding polycarbonate doors to seal the top and sides of the door.

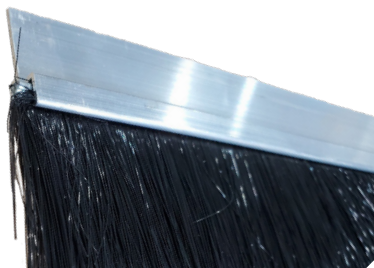

CATALOG #	DESCRIPTION
1118 0991	8' Long Brushed Seal

F-RAIL

Used in framing bench tops with expanded metal. No more exposed edges on expanded metal benches.

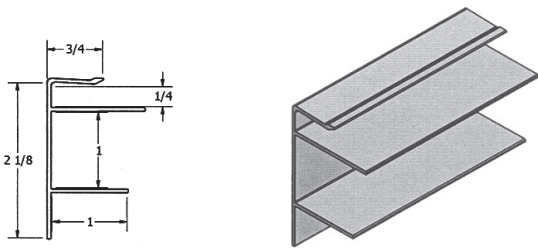

CATALOG #	DESCRIPTION
1332 1288	24' F Rail

FEMALE HINGE

The aluminum Female Hinge has been specifically designed for the E-ZY Grower Side Vent. When used with the Male Hinge it creates a movable profile (hinge) that allows the vent to swing open or closed. Attach Female Hinge to steel support with 1/4" x 1" tek screws every 18".

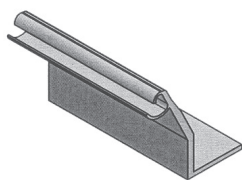

CATALOG #	DESCRIPTION
1318 1288	24' Female Hinge

MALE HINGE

The Male Hinge is used with the Female Hinge to complete the movable 'hinge' on our E-ZY Grower Vents. This 'hinge' that is created when the two profiles are joined together is the mechanism that allows the vents to open and close. No additional hardware is needed for assembly due to the self-locking design of the Male Hinge.

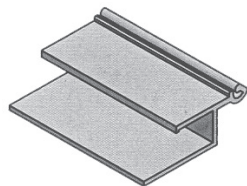

CATALOG #	DESCRIPTION
1319 1288	24' Male Hinge

GREENHOUSE CLAMPS, STRAPS, & BANDS

TENSION BANDS

Used on greenhouse endwalls to fasten 2 pieces of steel together.

USE 5/16" x 2" Carriage Bolt & Nut



CATALOG #	DESCRIPTION
1781 1300	Tension Bands, 1-3/8" HD11010
1781 1500	Tension Bands, 1-5/8"

BRACE BANDS

Used to attach truss rods, crossbraces to our E-ZY Grower Greenhouses.

Use 5/16" x 2" Carriage Bolt & Nut

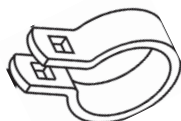

CATALOG #	DESCRIPTION
1780 1300	Brace Bands, 1-3/8" HD13010
1780 1500	Brace Bands, 1-5/8" HD13020
1780 0200	Brace Bands 2" HD13030

QUARTER CLAMPS

Use Round Clamps to secure purlin to first and last greenhouse bow. Square Clamps are used on endwall construction.



CATALOG #	DESCRIPTION
1782 1300	Quarter Clamps, 1-3/8" Round
1782 1200	Quarter Clamps, 1-1/4" Square

SPLIT T

Three way clamp used on ends to connect tubing together at perpendicular angles.

Use 5'1/6" x 2" Carriage bolt/nut.

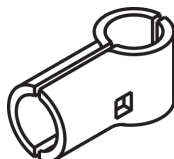

CATALOG #	DESCRIPTION
1792 1313	Split T, 1-3/8" x 1-3/8" HD2711
1792 1515	Split T 1 5/8" x 1 5/8" HD2112

STRAP CLAMPS

Use with 1/4" x 1" Tek Screws



CATALOG #	DESCRIPTION
1899 2110	1" w/ 2 holes (fits 1.315" steel)
1899 2111	1-1/4" w/ 2 holes (fits 1.625" steel)
1899 2112	1-1/2" w/ 2 holes (fits 1.9" steel)

CROSS CONNECTORS W/ HARDWARE

Used to attach purlin to bow.

- 1-3/8" used on our 20', 21', 24' greenhouses
- 1-5/8" used on our 30' greenhouses.

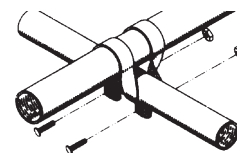

CATALOG #	DESCRIPTION
1797 1313	Cross Connectors, 1-3/8" x 1-3/8"
1797 1513	Cross Connectors, 1-5/8" x 1-3/8"
1797 0101	Cross Connectors 1" x 1"

BENCH CLAMPS

Round or Square clamps for attaching bench legs & crossbars

SOLD WITH HARDWARE

HALF CLAMP SOLD WITHOUT HARDWARE

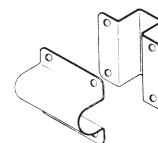

CATALOG #	DESCRIPTION
1795 1313	1-3/8" Round Clamp Pair
1795 1212	1-1/4" Square Clamp Pair
1795 1312	1-3/8" Rd x 1-1/4 Sq Clamp Pair
1794 1300	1-3/8" Rnd Aluminum Half Clamp w/o
1794 1200	1-1/4" SQ Aluminum Half Clamp

GREENHOUSE HARDWARE

ZINC TEK SCREWS

Self drilling screw for aluminum and steel.



CATALOG #	DESCRIPTION
1711 1075	#10 x 3/4" Tek Screw
1711 2510	1/4" x 1" Tek Screw
1711 2515	1/4" x 1.5" Tek Screw
1711 2516	1/4" x 1.5" Tek Screw & Washer
1711 2520	1/4" x 2" Tek Screw

PHILLIPS PAN HEAD SCREWS

Used to fasten steel splices and steel corners on our E-ZY Grower Benches. Use for attaching Aluminum Bar Cap to Aluminum Bar Base when securing polycarbonate.



CATALOG #	DESCRIPTION
1717 1005	#10 x 1/2" Phillips Pan Head Screw

WOOD-TITE SCREWS (HEX HEAD)

For fastening aluminium profiles to wood members.

CATALOG #	DESCRIPTION
1713 0915	#9 1/4" x 1-1/2"



PERMASEAL WASHERS & ZINC FLAT WASHERS

Permaseal Washers are for use on polycarbonate where tek screws to help seal and prevent excessive indentation into polycarb sheet. Flat Washers are applied to help seal and prevent excessive indentation into polycarb sheet. Flat Washers are for other general use.



CATALOG #	DESCRIPTION
1735 1180	#14 x 1-1/8" Permaseal Washer
1713 0915	1/4" Flat

U BOLTS

Use to attach wind/knee braces to E-ZY Grower Greenhouse. The 1-3/4" fits our 15', 20', 21', & 24' structures. The 2" fits our 30' structures.



CATALOG #	DESCRIPTION
1708 1799	U Bolt Kit, 1-3/4" x 3" x 1/4" w/ backplate and 2 nuts
1708 0299	U Bolt Kit, 2" x 3-1/4" x 1/4" w/ backplate and 2 nuts

ZINC CARRIAGE BOLTS

Smooth round head for appearance, security and safety. Measure from underside of head to tip of bolt.



CATALOG #	DESCRIPTION
1702 2515	1/4" x 1.5" Carriage Bolt
1702 2525	1/4" x 2.5" Carriage Bolt
1702 2560	1/4" x 6" Carriage Bolt
1702 3825	3/8" x 2.5" Carriage Bolt
1702 5620	5/16" x 2" Carriage Bolt
1702 5625	5/16" x 2.5" Carriage Bolt

ZINC HEX HEAD BOLTS

Common grade for general purpose fastening. Measure from the underside of head to tip of the bolt.



CATALOG #	DESCRIPTION
1700 2507	1/4" x 3/4" Hex Head Bolt
1700 2515	1/4" x 1.5" Hex Head Bolt
1700 2520	1/4" x 2" Hex Head Bolt
1700 2525	1/4" x 2.5" Hex Head Bolt
1700 3835	3/8" x 3.5" Hex Head Bolt

ZINC HEX NUTS

For general purpose applications-Most commonly used nut. Use lock nuts where vibration may cause loosening.

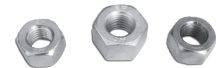

CATALOG #	DESCRIPTION
1720 2500	1/4" Hex Nut
1720 5600	5/16" Hex Nut
1720 3800	3/8" Hex Nut
1726 2500	1/4" Lock Nut

MENDING & SPLICE PLATES BENCH CORNERS

Use TD Plates for general repairs. Use 2" Splice on Bench F-Rail to extend long runs. Steel Corners provide smooth - safety finish to bench tops.

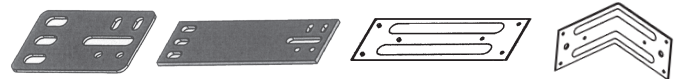

CATALOG #	DESCRIPTION
1798 2304	4" T.D. Mending Plate
1798 2308	8" T.D. Mending Plate
1798 0206	2" x 6.5" Splice
1770 1040	Steel Bench Corner

GALVANIZED STEEL TUBING

ROUND STEEL TUBING

Catalog #	Size	Gauge	Bundle Qty.
14-108288	1" x 24'	18	127
14-104288	1" x 24'	14	127
14-148195	1.315" x 16' 3"	18	91
14-148288	1.315" x 24'	18	91
14-144171	1.315" x 14' 3"	14	91
14-144187	1.315" x 15' 7"	14	91
14-144243	1.315" x 20' 3"	14	91
14-144288	1.315" x 24'	14	91
14-183288	1.625" x 24'	13	61
14-204234	1.66" x 19' 6"	14	61
14-204288	1.66" x 24'	14	61
14-283288	1.9" x 24'	13	61



ROUND SWEDGED STEEL TUBING

Catalog #	Size	Gauge	Bundle Qty.
14-108288S	1" x 24'	18	127
14-148195S	1.315" x 16' 3"	18	91
14-144243S	1.315" x 20' 3"	14	91
14-204234S	1.66" x 19' 6"	14	61



SQUARE STEEL TUBING

Catalog #	Size	Gauge	Bundle Qty.
15-108288	1" x 24'	18	160
15-204288	1.25" x 24'	14	121
15-306288	1.5" x 24'	16	81
15-505288S	2" x 24' SW Edged	15	25



RECTANGULAR STEEL TUBING

Catalog #	Size	Gauge	Bundle Qty.
16-106288	1" X 2" x 24'	16	96



Don't see the style and length you need?

Reach out to Griffin Construction at
constructiondept@griffinmail.com

GREENHOUSE STRUCTURES

QUICK & E-ZY SLIDING DOOR KITS



3' x 8' DOOR

Steel Frame Only

Track, Trolley, Hardware

Polycarbonate Covering & Aluminum Extrusions & Door Brush Seal

4' x 8' DOOR

Steel Frame Only

Track, Trolley, Hardware

Polycarbonate Covering & Aluminum Extrusions & Door Brush Seal



5' x 8' DOOR

Steel Frame Only

Track, Trolley, Hardware

Polycarbonate Covering & Aluminum Extrusions & Door Brush Seal

6' x 8' DOOR

Steel Frame Only

Track, Trolley, Hardware

Polycarbonate Covering & Aluminum Extrusions & Door Brush Seal



NEED A SPECIAL SIZE? NO PROBLEM!

We can easily customize almost any size door frame.

Reach out to Griffin Construction at
constructiondept@griffinmail.com

GREENHOUSE STRUCTURES

DOOR ACCESSORIES

DOOR TRACK

Rollformed from galvanized steel and can support up to 400 lbs. It is used not only as a door track, but also to construct our E-ZY Door Frames.

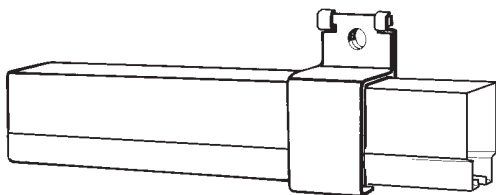

CATALOG #	DESCRIPTION
17-630106	6' Door Track
17-630108	8' Door Track
17-630110	10' Door Track
17-630112	12' Door Track

DOOR HANGERS

An economical nylon-bearing hanger typically used on metal frame doors weighing up to 400 lbs. The drop bolt installs vertically through top frame member of door. Vertical adjustment only. Steel wheels, frame and axles with solid nylon bearings.

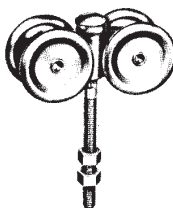

CATALOG #	DESCRIPTION
17-620457	Door Hanger for Metal Doors

7" DOOR HANDLE



CATALOG #	DESCRIPTION
17-650700	7" Door Handle 1XMY8

STAY ROLLS

STAY ROLL 93: For floor-mounted applications. Includes lag screw and expansion shield. Steel with hard rubber wheel.



STAY ROLL: A compact stay roll which installs

at the base of the jamb on each side of the door opening to guide the sliding door during operation. Adjustable for doors up to 2-1/2". Steel w/ lexan wheel. Use 1/4" tek screw or 1/4" bolt with a washer and nut to attach Stay Roll to metal surfaces.

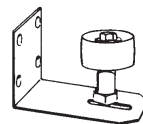

CATALOG #	DESCRIPTION
17-609300	Stay Roll #93
17-600468	Stay Roll

BRASKETS

SINGLE SIDE BRACKET:

Used for face mounted applications requiring a single run of Track #301. The front of the bracket pivots outward, allowing for easy installation of the Door Track #301. Attaches with a 3/8" hex head bolt with a washer and nut for most applications.

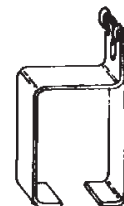

CATALOG #	DESCRIPTION
17-611301	Single Side Bracket

DOOR BRUSH SEAL

Door brush seal is used around sliding polycarborante doors to seal the top and sides of the door.

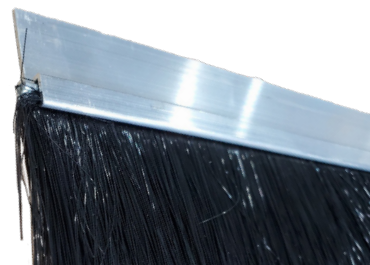

CATALOG #	DESCRIPTION
1118 0991	8' Long Brushed Seal

E-ZY GROWER ROOF & RIGID SIDE VENTS



NATURAL VENTILATION

Our E-ZY Grower Vents can be adapted to most structures and work great for replacement of old worn out vents. Made with heavy duty aluminum extrusions and covered with polycarbonate. Our vents will give years of troublefree use. The Ridge Vent is used to allow warm air to rise out through the top of the greenhouse, while cool air comes in through the Side Vent. Both styles are available in custom lengths and widths.

KIT INCLUDES:

- Rigid aluminum frame extrusions
- Hardware
- Instructions



POLY ROOF VENT SIDE VIEW

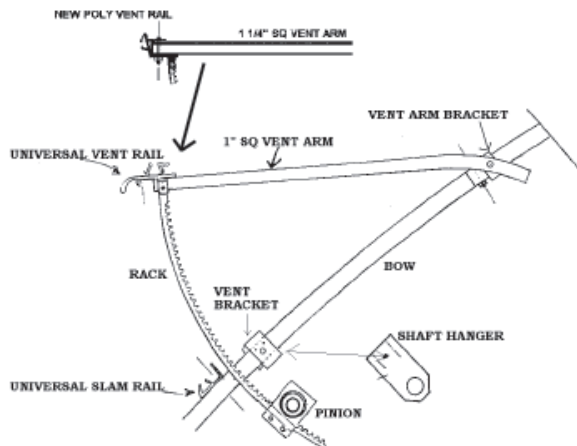

**EMAIL CONSTRUCTIONDEPT@GRIFFINMAIL.COM OR
CALL US FOR YOUR CUSTOM VENT QUICK QUOTE!**

GREENHOUSE ACCESSORIES

POWERRACK™ RACK & PINION PACKAGE

CAN YOU SEE THE DIFFERENCE?

Successful growers can. It's the unrivaled quality built into every PowerRack™ rack and pinion. While some rack arms are dry cut, the teeth on Wadsworth's PowerRack™ arms are cut under an oil bath to minimize sharp edges and assure smooth operation. The holes in the pinion housing are punched with a precision stamping tool to maintain exact spacing. All clevis pins, cotterpins and set screws are made from quality stainless steel.

WHY CURVED?

The curved PowerRack™ rack & pinion is designed to give additional clearance (54" radius) when space is tight. When a straight rack might interfere with a curtain or aisle, growers find the curved rack to be the answer!

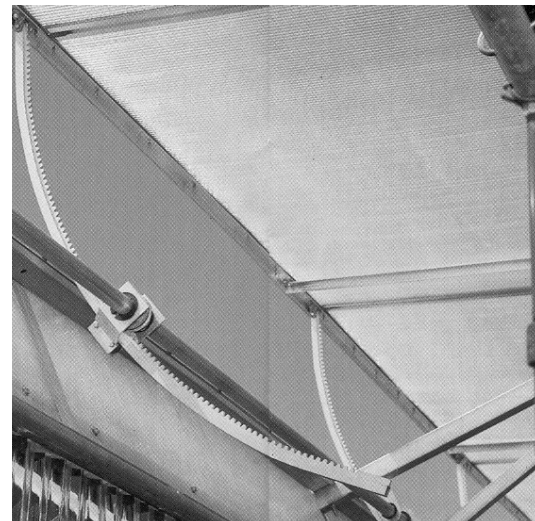
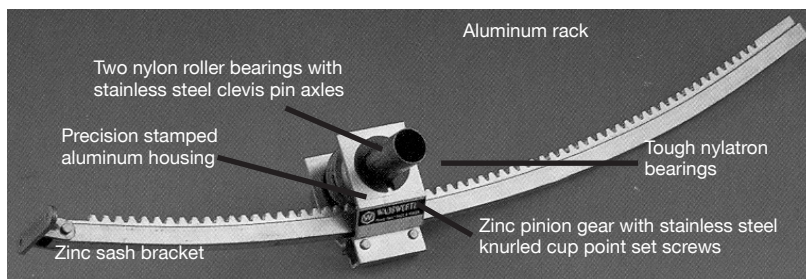

CURVED POWERRACK™ MOUNTED ON GREENHOUSE WITH VENT IN A PARTIALLY OPENED POSITION.

POWERRACK™ FEATURES:

- Wide load-bearing surfaces.
- Replaceable Parts: Every part is replaceable using ordinary hand tools.
- Freedom from corrosion: Aluminum rack and housing, zinc pinion gear, tough nylon bearings. Easy alignment: Rack works even when it's not perfectly square with vent.
- Economically priced.

PowerRack Packages: Complete with rack, pinion with housing and sash bracket

Item # 1-3/8"	Item # 1-5/8"	STRAIGHT RACK
M-2636	M-2736	36" PowerRack Package w/ straight rack
M-2642	M-2742	42" PowerRack Package w/ straight rack
M-2648	M-2748	48" PowerRack Package w/ straight rack
M-2653	M-2753	53" PowerRack Package w/ straight rack
M-2666	M-2766	66" PowerRack Package w/ straight rack
M-2672	M-2772	72" PowerRack Package w/ straight rack

Item # 1-3/8"	Item # 1-5/8"	CURVED RACK
M-2836	M-2936	36" PowerRack Package w/ curved rack
M-2842	M-2942	42" PowerRack Package w/ curved rack
M-2848	M-2948	48" PowerRack Package w/ curved rack
M-2853	M-2953	53" PowerRack Package w/ curved rack
M-2866	M-2966	66" PowerRack Package w/ curved rack
M-2872	M-2972	72" PowerRack Package w/ curved rack

All PowerRack Packages are special ordered, please allow ample time for delivery. 1-5/8" Shaft Opening (1.66 tubing) is also available, please request when ordering. All prices are FOB Arvada CO.

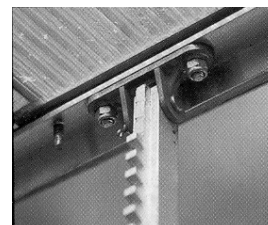

CLOSEUP OF MOUNTED POWERRACK™ SASH BRACKET

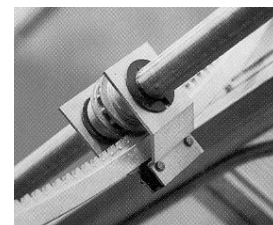

CLOSEUP OF MOUNTED POWERRACK™

SHAFT HANGERS

Used to hold roll tube shaft on rack and pinion vent systems. Place every 4-6 foot.

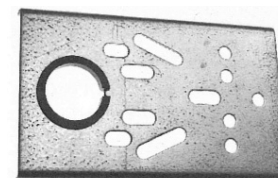

Available in 2 sizes: 1-3/8" and 1-5/8".

Catalog #	Description
12-130016	Shaft Hanger, (for 1.315 OD)
12-110006	#S2806 Universal Shaft Hanger, 1-3/8"
12-110008	#S2808 Universal Shaft Hanger, 1-5/8"

MONORAIL ASSEMBLY PARTS

RAIL STOPS (FOR RAIL SUPPORTS)

Used to stop and collect trolleys or hangers on rails at desired points.

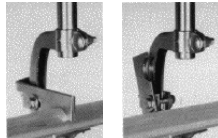

Part #	Tube Size	Dimensions						Wt/100 Pcs	Pcs/ Carton
		A	B	C	D	E	F		
101	1-5/18"	4-7/8"	1-1/8"	1"	1-3/4"	1/4"	1/2"	62 lbs	100

TROLLEY HEADS

Two wheel trolley head: 1" wide steel wheels

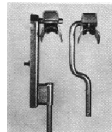

RAIL SUPPORTS

Designed for 3/4" pipe drop used with 1-5/16" (1.315) rail tubing.

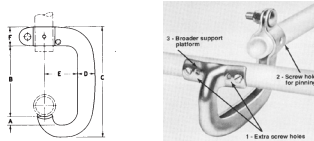

Part #	Size I.P.S.	Dimensions						Load Cap.	Mat'l	Wt/ 100 Pcs
		A	B	C	D	E	F			
0030	3/4"	1/2"	4-1/4"	6-5/8"	1"	2"	1-1/8"	750 lbs	Steel	80 lbs

CLOSE RAIL SUPPORTS

This Close Rail Support bolts directly to angle iron, underside of beams and door frames. Used where other pipe suspensions are not practical.



Part #	Dimensions						Load Cap.	Mat'l	Wt/ 100 Pcs
	A	B	C	D	E				
2103	1/2"	1-15/16"	5-3/8"	2-11/16"	3/16"		500 lbs	Steel	160 lbs

SPEED RAIL & SPEED CURVES

SPEED RAIL: Tubing swedged on one end used as rail for monorail cart to travel on. 1.315, 14 gauge galvanized steel.

SPEED CURVE: 1.315, 14 gauge galvanized steel tubing. Length: 6' long, swedged on one end. Use one 57° curve w/ curved switches to give a 90° turn.



SINGLE ARM BRACKETS

Uses U-Bolt to lock any type of upright support without slipping.



Part #	Size I.P.S.	Dimensions						Wt. per 100 Pcs.
		A	B	C	D	E	F	
2401	1"	1-7/8"	1/2"	7-1/4"	1-3/4"	9"	1-5/16"	235 lbs.
2402	1"	1-7/8"	1/2"	10-1/4"	1-3/4"	12"	1-5/16"	300 lbs.
2403	1"	1-7/8"	1/2"	11-3/4"	1-3/4"	13-1/2"	1-5/16"	315 lbs.
2404	1"	2-1/8"	1/2"	13-1/4"	1-3/4"	15"	1-5/16"	335 lbs.
2405	1-1/4"	1-7/8"	1/2"	10-1/4"	1-3/4"	12"	1-21/32"	305 lbs.
2406	1-1/4"	1-7/8"	1/2"	11-3/4"	1-3/4"	13-1/2"	1-21/32"	320 lbs.
2407	1-1/4"	2-1/8"	1/2"	13-1/4"	1-3/4"	15"	1-21/32"	350 lbs.
2410	2"	2-1/8"	1/2"	13-1/4"	1-3/4"	15"	2-3/8"	370 lbs.

CATALOG #	CARTS
18-036000	Monorail Cart w/ 3 Shelves
18-040000	Monorail Cart w/ 4 Shelves
18-050000	Monorail Cart w/ 5 Shelves

NOTE: Does not include shelf bottoms (Frame Only)

CATALOG #	SHELVES & INSERTS
18-026000	Monorail Shelf Frame Only
20-020699	Expanded Metal Shelf Inserts - 6' x 2'
29-186024	Polycarbonate Shelf Inserts - 6' x 2'

CATALOG #	SWITCHES
18-502710	#2710R Right Curved Lever Switch
18-512710	#2710L Left Curved Lever Switch
18-242800	#2810R Right Drop-Off Curved Switch
18-452810	#2810L Left Drop-Off Curved Switch
18-242900	#2910 Straight Lever Switch
18-242610	#2610 Straight Drop-Off Switch
18-222151	#2151 Master Switch, crss thru manual
18-230201	#2010RI Right Inside Master Switch
18-231201	#2010LI Left Inside Master Switch
n/a	#2010RO Right Outside Master Switch
n/a	#2010LO Left Outside Master Switch
18-262000	#2751 Knife Switch (R-7) 20" Long
18-212851	#2851 Removable Bar Switch - 24" Long

CATALOG #	BRACKETS
18-492401	Single Arm Bracket #2401
18-492402	Single Arm Bracket #2402
18-492403	Single Arm Bracket #2403
18-492404	Single Arm Bracket #2404
18-492405	Single Arm Bracket #2405
18-492406	Single Arm Bracket #2406
18-492407	Single Arm Bracket #2407
18-492410	Single Arm Bracket #2410

CATALOG #	CLAMPS & MORE
18-992111	#2111 Strap Clamp
18-900031	Steel Clamp Set #0031
18-900032	Steel Clamp Set #0032
18-900033	Steel Clamp Set #0033
18-900034	Steel Clamp Set #0034
18-900035	Steel Clamp Set #0035
18-900136	Steel Clamp Set #0036
18-721000	#C15540 Two Wheel Trolley Head
18-800300	Rail Support #C00300
18-881010	Rail Stop #1010
18-882103	Close Rail Support #2103
18-545000	45 degree Speed Curve
18-557000	57 degree Speed Curve
18-590000	90 degree Speed Curve

PLANT DISPLAYS



E-ZY MINI BASKET ARBOR

The Mini Basket Arbor is designed to be an extra sales tool for year round displays - compact enough to place almost anywhere, yet holding enough product to have real sales impact! It holds 42 full 10" hanging baskets and assembles easily.

CASTER OPTION (1110 2999): CALL FOR PRICING

Make it an E-ZY to roll, portable display unit. Load it up and wheel it at the front of your retail site for roadside display. At closing time, just wheel inside! Includes: 4 heavy-duty 5" polyolefin casters.

Catalog #	Description
1110 2031	Arbor ONLY (3.5' W x 6' L x 7' H)



E-ZY BASKET ARBOR

Our basket arbors are built to last and designed to make you a profit immediately! Now you can display all your hanging baskets in one attractive, money-making area without the hassle and expense of trying to build your own display. These units are designed for quick and easy assembly on almost any surface. Put one up and watch those baskets SELL, SELL, SELL!

SPECIFICATION

- Bows: 1.315 14-gauge steel tubing.
- Purlins: 1.315 17-gauge steel tubing
- Arbor height at peak: 8'.
- Swedged bow slides easily into center piece and is fastened with a 1/4" x 2" carriage bolt and nut.

Catalog #	Description
1110 0091	9½' x 8' E-ZY Basket Arbor w/ 2 bows & 8 Purlins
1110 0092	9½' x 12' E-ZY Basket Arbor w/ 3 Bows & 8 Purlins
111 00093	9½' x 20' E-ZY Basket Arbor w/ 3 Bows & 8 Purlins



PLANT DISPLAYS



E-ZY BASKET CURVE

The all steel construction of our 12' Starter Unit assembles easily to generously display 36 or more full-bloom spreading baskets with enough spacing to avoid damage. The continuous curve of color will WOW your customers and your basket sales!

Really knock their socks off with two E-ZY Basket Displays loaded on either side of your entrance or for impulse buys at the check out!

Catalog #	Description
1115 9120	E-ZY Basket Curve 12' Starter Unit
1464 4288	Banner Bar
9303 2500	Custom Banner to fit Banner Bar (30" x 120")



BASKETS GET SEEN AND SOLD WHEN DISPLAYED ON OUR E-ZY BASKET CURVE DISPLAY!



E-ZY STACK DISPLAY BENCH

Add an instant display anywhere with our quick set stackable benches. Sturdy yet elegant design with clear glass-look top, accents your mixed containers, baskets and tie in products for added impulse sales. E-ZY Assembly.

- Width x Length
1'x 4' | 1'x 6' | 2' x 4' | 2' x 6' | 3' x 4' | 3' x6' | 4' x 4' | 4'x 6'
- Leg Height
12"





ONLINE ORDERING

www.griffins.com

CONTACT GRIFFIN

Email: orders@griffinmail.com

Phone: 800.888.0054

Grower/Retail Fax: 877.636.3623

Plant & Seed Fax: 610.913.3091

PLANTS & SEED | GROWER SUPPLIES | RETAIL | CEA | CONSTRUCTION

© 2025 Griffin Greenhouse Supplies, Inc. The trademarks displayed or otherwise used herein are registered and unregistered trademarks of Griffin Greenhouse Supplies, Inc., or third parties.



GRIFFIN